

5mm Round White LED (T-1 3/4)

Features

- Fluorescence Type
- High Luminous Intensity
- High Efficiency
- Emission Color: $x=0.29, y=0.30$



T-1 3/4

Descriptions

The White LED which was fabricated with a blue LED and a phosphor, and the phosphor is excited by blue light and emits yellow fluorescence. The mixture of blue light and yellow light results in a white emission

Applications

- OA Equipment
- Backlighting of LCD
- Automotive Equipment
- Replacement of Conventional Light Bulbs and Fluorescent Lamps

Device Selection Guide

Part No.	Chip		Lens Color
	Material	Emitted Color	
TLH-W1R5-3831BB	InGaN	White	Water Clear

5mm Round LED

TLH-W1R5-3831BB

Absolute Maximum Ratings (Ta=25°C)

Parameter	Symbol	Value	Unit
Reverse Voltage	VR	5	V
Forward Current	IF	30	mA
Pulse Forward Current (Note 1)	IFP	100	mA
Power Dissipation	Pd	120	mW
Soldering Temperature (Note.2)	Tsol	260	°C
Operating Temperature	Topr	-30 ~ +80	°C
Storage Temperature	Tstg	-40 ~ +100	°C

- Notes:** 1. IFP conditions: Pulse Width ≤10 milliseconds and Duty ≤1/10.
2. Soldering time ≤ 5 seconds.

Electro-Optical Characteristics (Ta=25°C)

Parameter	Symbol	Min.	Typ.	Max.	Unit	Condition
Luminous Intensity	Iv	1500	2300	-----	mcd	IF =20mA
Viewing Angle	2θ1/2	-----	13	-----	deg	
Forward Voltage	VF	-----	3.6	4.0	V	
Reverse Current	IR	-----	-----	10	μA	VR=5V
Chromaticity Coordinates(Note 1)	x	-----	0.29	-----	-----	IF =10mA
	y	-----	0.30	-----	-----	

- Notes:** 1. The CIE 1931 Chromaticity diagram.
2. The products are sensitive to static electricity, need to be carefully handling.
3. Tolerance of Luminous Intensity: ±10%.
4. Tolerance of Forward Voltage: ±0.1V

5mm Round LED

TLH-W1R5-3831BB

Typical Electro-Optical Characteristics Curves (Ta=25°C)

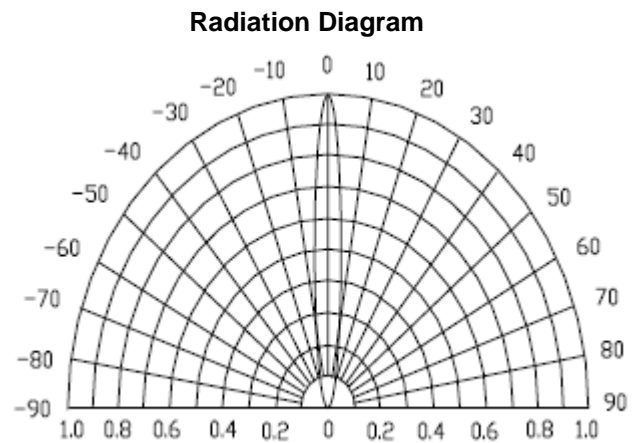
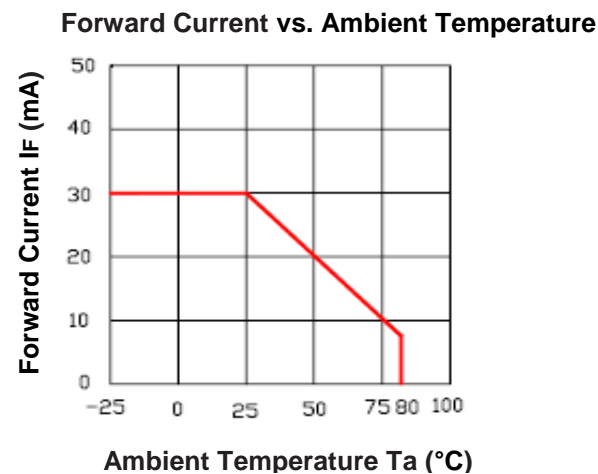
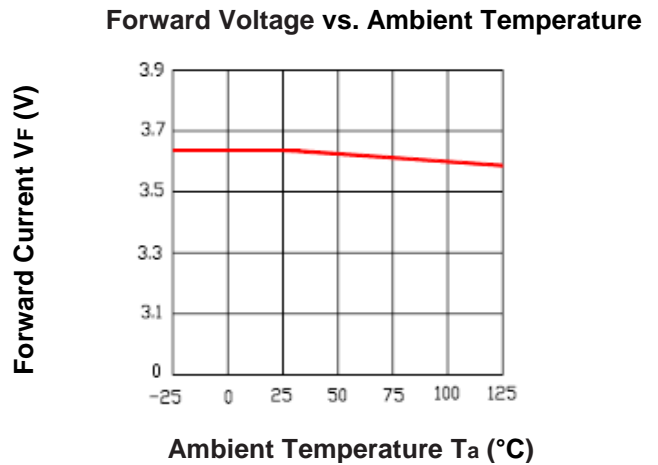
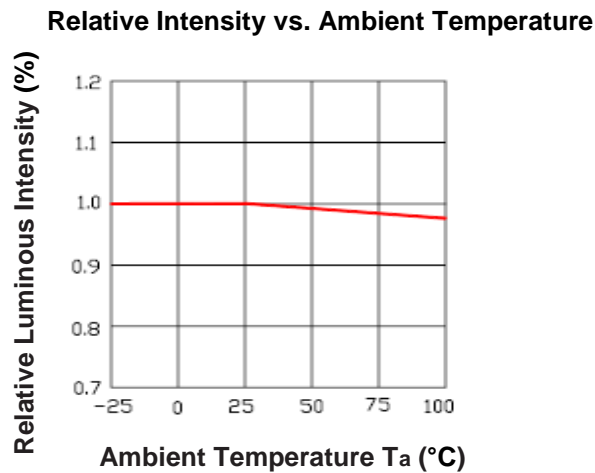
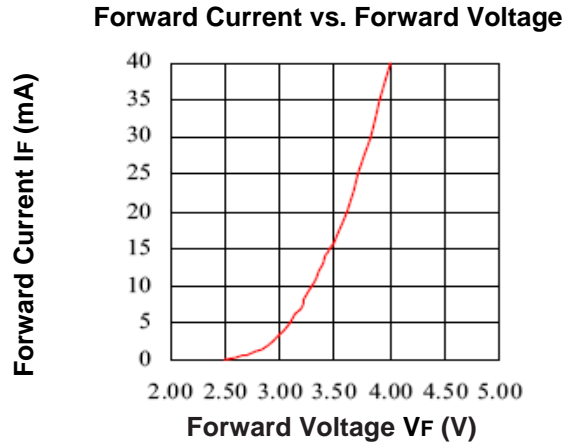
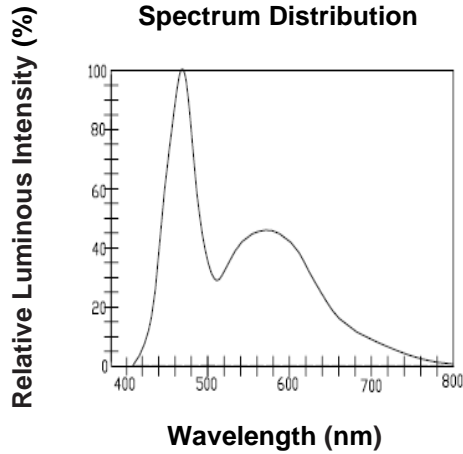

5mm Round LED

TLH-W1R5-3831BB

Package Dimensions (In mm)

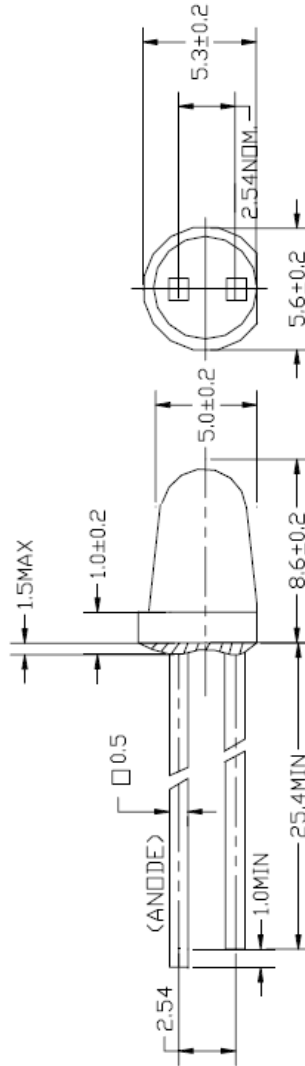

Note: All dimensions are in millimeters, and tolerance is 0.25mm without special declared.

Packing Quantity Specification

Packing Type	PCS per Bag	PCS Per Inner Box	PCS Per Carton
Bulk	500	2,500	25,000

5mm Round LED

TLH-W1R5-3831BB-92-B

Ordering Information

TL H - W 1 R 5 - 383 1B B - 92 - B

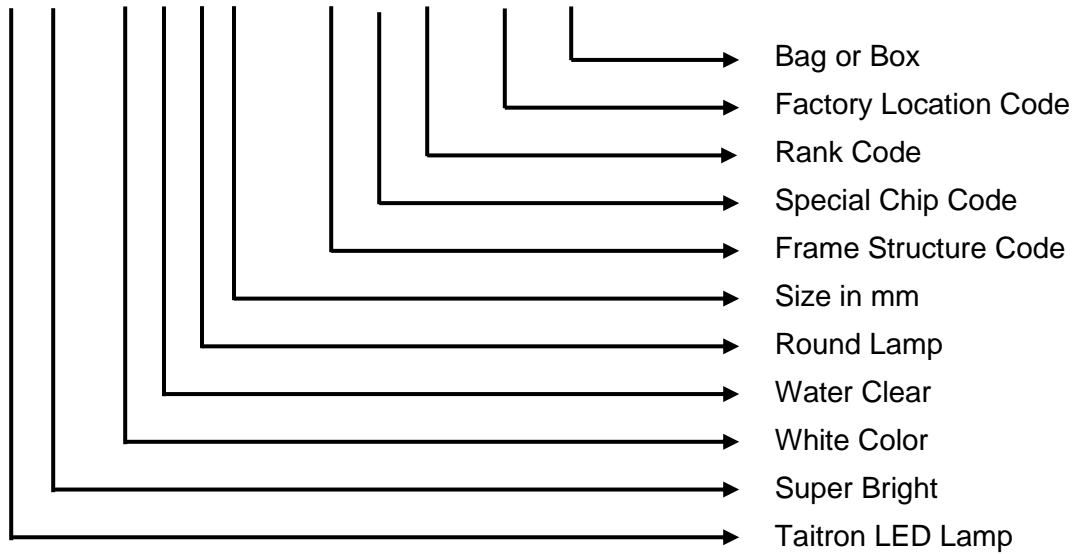

Rank Combination

Chromaticity Coordinates Specifications for Bin Group

Groups	Chromaticity Coordinates				
A	x	0.22	0.22	0.26	0.26
	y	0.22	0.28	0.31	0.25
B	x	0.26	0.26	0.29	0.29
	y	0.25	0.31	0.33	0.27
C	X	0.29	0.29	0.32	0.32
	y	0.27	0.33	0.35	0.29
D	x	0.32	0.32	0.36	0.36
	y	0.29	0.35	0.38	0.32

Note: Tolerance x ± 0.02, y ± 0.02.

5mm Round LED TLH-W1R5-3831BB

CIE Chromaticity Coordinates Diagram

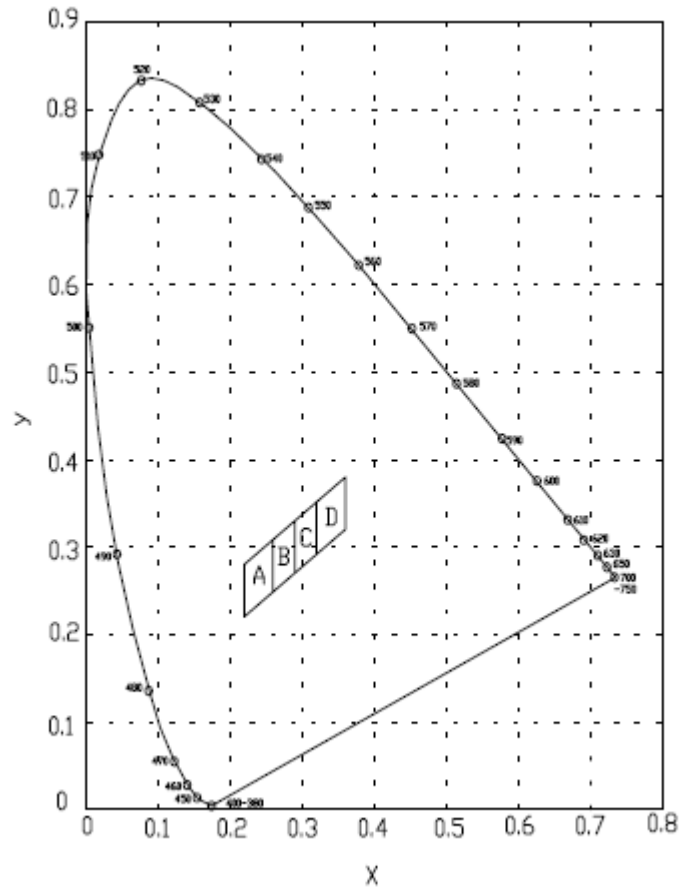

How to contact us

USA HEADQUARTERS

28040 WEST HARRISON PARKWAY, VALENCIA, CA 91355-4162

Tel: (800)-TAITRON (800)-824-8766 (661)-257-6060

Fax: (800)-TAITFAX (800)-824-8329 (661)-257-6415

Email: taitron@taitroncomponents.com

Http://www.taitroncomponents.com

TAITRON COMPONENTS INCORPORATED TAIWAN BRANCH

6F., NO.190, SEC. 2, ZHONGXING RD., XINDIAN DIST., NEW TAIPEI CITY 23146, TAIWAN R.O.C.

Tel: 886-2-2913-6238

Fax: 886-2-2913-6239

TAITRON COMPONENT TECHNOLOG SHANGHAI CORPORATION

SUITE 1503, METROBANK PLAZA, 1160 WEST YAN'AN ROAD, SHANGHAI, 200052, CHINA

Tel: +86-21-5424-9942

Fax: +86-21-2302-5027