

5mm Round LED (T-1 3/4)

Features

- Popular T-1 3/4 colorless 5mm package
- High luminous power
- Typical chromaticity coordinates $x=0.29$, $y=0.28$ according to CIE1931
- Bulk, available taped on reel
- RoHS compliance



QRLHW1R5



Applications

- Outdoor Displays
- Optical Indicators
- Backlighting
- Marker Lights

Descriptions

- The series is designed for application required high luminous intensity.
- The phosphor filled in the reflector converts the blue emission of InGaN chip to ideal white.

Device Selection Guide

Part No.	Chip		Lens Color
	Material	Emitted Color	
TLH-W1R5-3332X9	InGaN / Sapphire	White	Water Clear

5mm Round LED

TLH-W1R5-3332X9

Absolute Maximum Ratings (Ta=25°C)

Parameter	Symbol	Value	Unit
Reverse Voltage	V_R	5	V
Continuous Forward Current	I_F	25	mA
Peak Forward Current (Duty 1/10 @1KHz)	I_{FP}	100	mA
Power Dissipation	P_d	100	mW
Electrostatic Discharge (HBM)	ESD	150	V
Soldering Temperature (T=5 sec)	T_{sol}	260 ±5	°C
Operating Temperature	T_{opr}	-40 ~ +85	°C
Storage Temperature	T_{stg}	-40 ~ +100	°C

Electro-Optical Characteristics (Ta=25°C)

Parameter	Symbol	Min.	Typ.	Max.	Unit	Condition
Luminous Intensity	I_v	7150	9000	-----	mcd	IF =20mA
Viewing Angle	2θ1/2	-----	20	-----	deg	IF =20mA
Forward Voltage	V_F	-----	3.5	4.0	V	
Reverse Current	I_R	-----	-----	50	μA	VR=5V
Chromaticity Coordinates	x	-----	0.29	-----	-----	IF =20mA
	y	-----	0.28	-----	-----	-----

5mm Round LED

TLH-W1R5-3332X9

Typical Electro-Optical Characteristics Curves

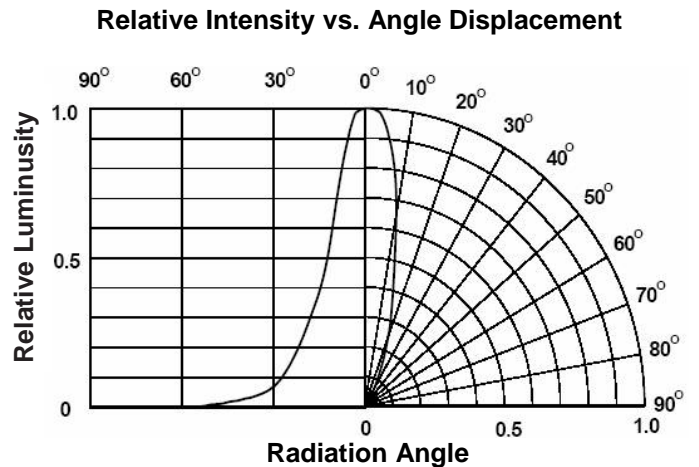
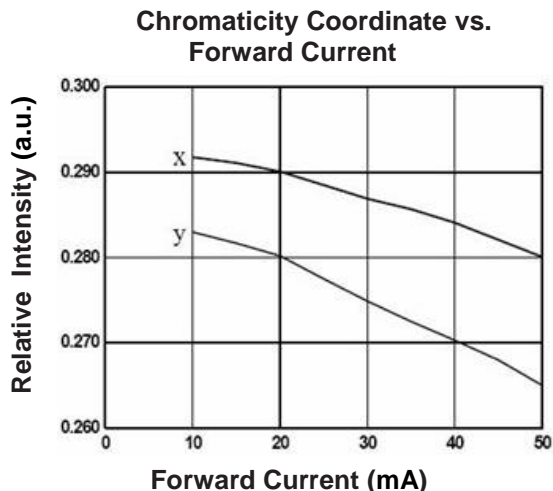
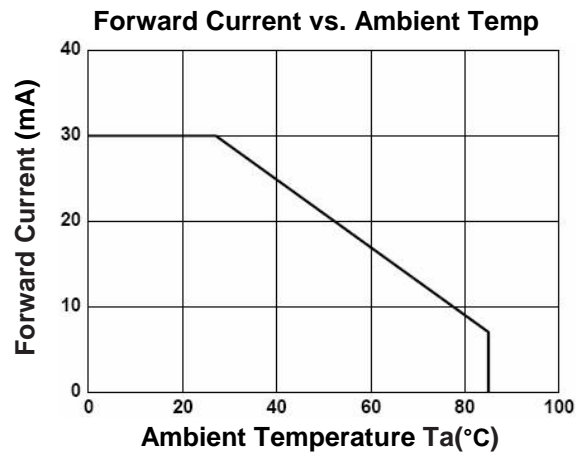
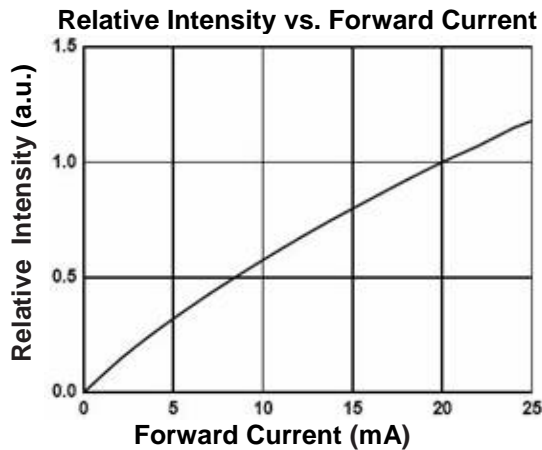
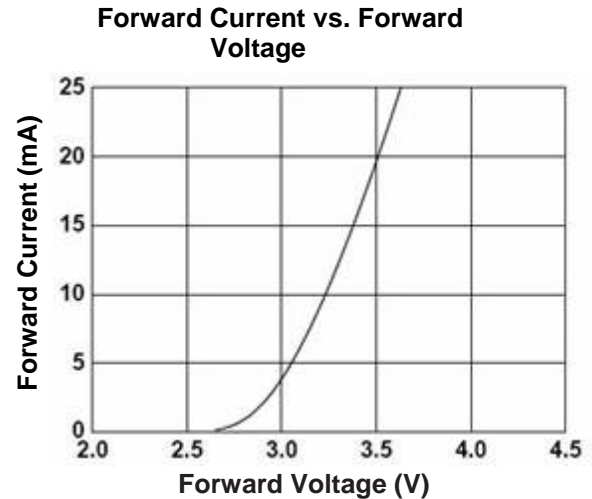
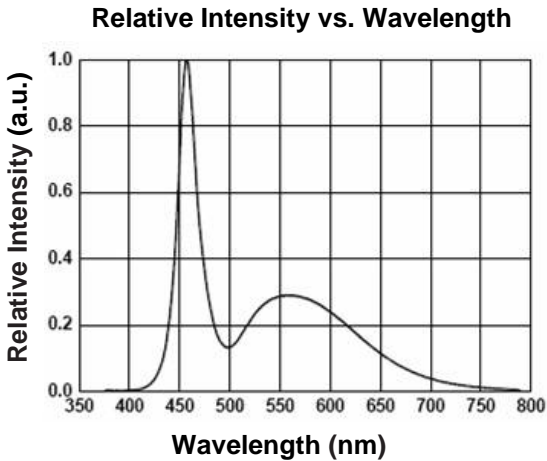

5mm Round LED

TLH-W1R5-3332X9

Package Dimensions (In mm)

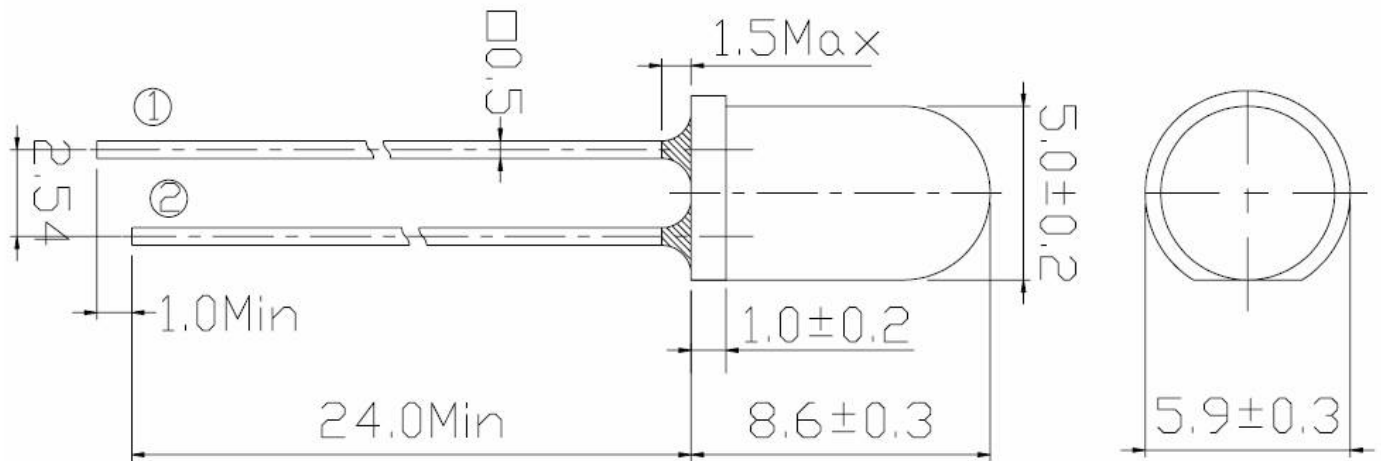

Note:

1. All dimensions are in millimeters, and tolerance is 0.25mm except being specified
2. Lead spacing is measured where the lead emerges from the package
3. Protruded resin under flange is 1.5mm Max. LED

Ordering Information

TL H -W 1 R 5 -3332 X9 -92 TR70

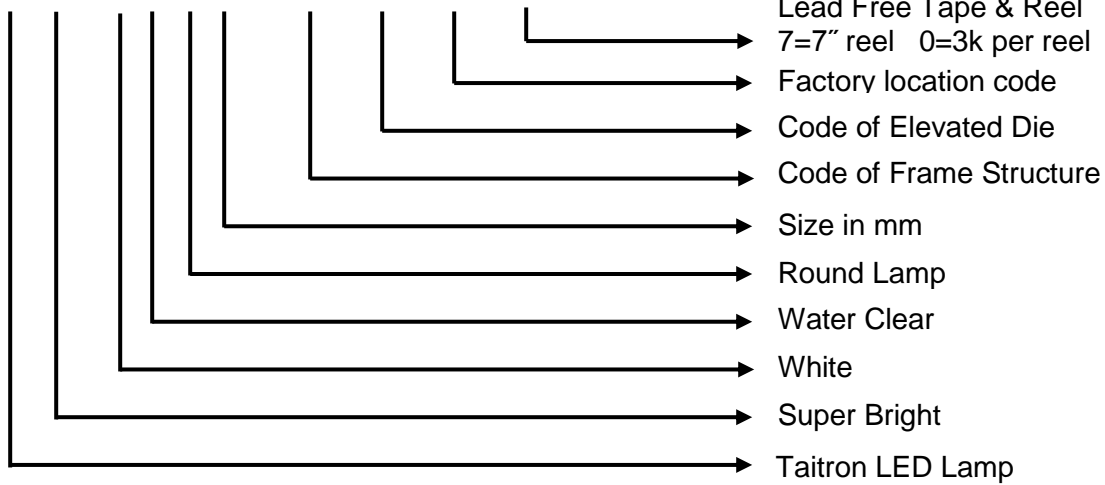

Luminous Intensity Combination (mcd at 20mA)

Iv Ranks	J2	K1	K2	L1
Min.	7150	9000	11250	14250
Max.	9000	11250	14250	18000

Measurement Uncertainty of Luminous Intensity: ±15%

Forward Voltage Combination (V at 20mA)

Rank	1	2
Min.	3.0	3.5
Max.	3.5	4.0

Measurement Uncertainty of Forward Voltage: ±0.1V

Color Ranks (IF=20mA, Ta=25°C)

Color Ranks	CIE X		CIE Y	
	Min.	Max.	Min.	Max.
A1	0.215	0.245	0.155	0.215
A2	0.245	0.260	0.185	0.245
B1	0.260	0.275	0.215	0.275
B2	0.275	0.290	0.245	0.295
C1	0.290	0.305	0.275	0.315
C2	0.305	0.320	0.295	0.335
D1	0.320	0.340	0.315	0.355
D2	0.340	0.360	0.335	0.385

Measurement uncertainty of the color coordinates: ± 0.01

CIE Chromaticity Diagram

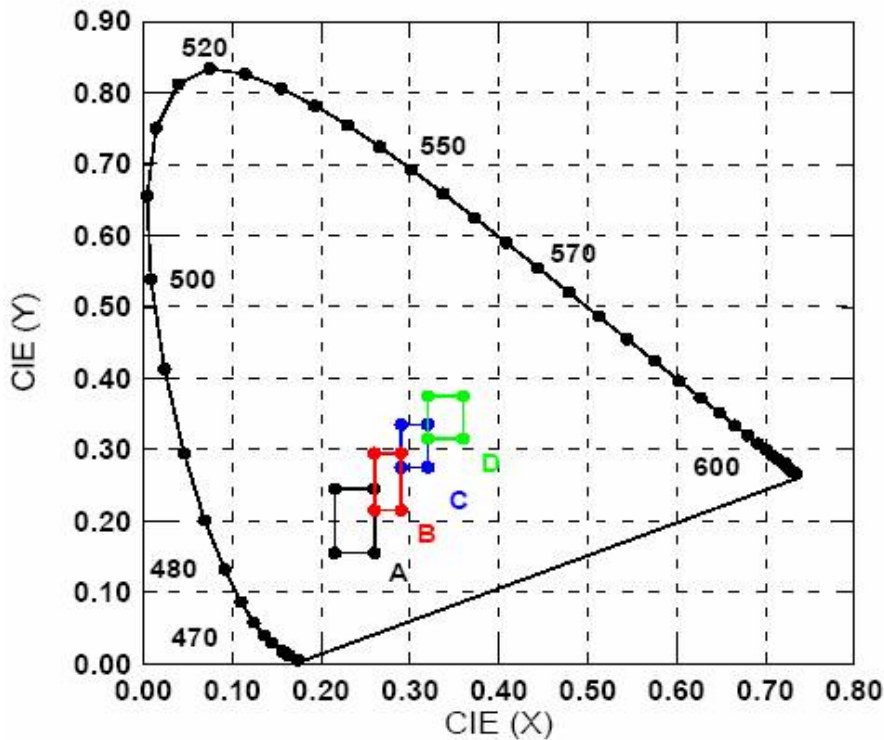

How to contact us

USA HEADQUARTERS

28040 WEST HARRISON PARKWAY, VALENCIA, CA 91355-4162

Tel: (800)-TAITRON (800)-824-8766 (661)-257-6060

Fax: (800)-TAITFAX (800)-824-8329 (661)-257-6415

Email: taitron@taitroncomponents.com

Http://www.taitroncomponents.com

TAITRON COMPONENTS INCORPORATED TAIWAN BRANCH

6F., NO.190, SEC. 2, ZHONGXING RD., XINDIAN DIST., NEW TAIPEI CITY 23146, TAIWAN R.O.C.

Tel: 886-2-2913-6238

Fax: 886-2-2913-6239

TAITRON COMPONENT TECHNOLOG SHANGHAI CORPORATION

SUITE 1503, METROBANK PLAZA, 1160 WEST YAN'AN ROAD, SHANGHAI, 200052, CHINA

Tel: +86-21-5424-9942

Fax: +86-21-2302-5027