

0.05" Centerline Through Hole PLCC IC Socket

Features

- Insulator: Thermoplastic, PPS Glass Fiber Filled(UL 94V-0)
- Contact: Phosphor Bronze
- Contact plating: 150u" Tin plating over 30u" to 50u" Nickel
- Polarization mark
- Storage Temperature: -20~70°C
- Operating Temperature: -45-105°C



Electrical Performance

Description	Data	Unit	Condition
Contact Resistance (Max.)	20	mΩ	EIA 364-23 Subject mated contacts assembled in housing to closed circuit current of 100 mA at open circuit at 20 mV
Insulation Resistance (Min.)	1000	MΩ	EIA 364-21 Test voltage: 500VDC
Dielectric withstanding voltage	No disruptive discharge leakage or deterioration		EIA 364-20 500VAC for 60 seconds

Mechanical Performance

Description	Result	Condition
Durability	No evidence of damage	EIA 364-09 Test Cycles : 50 cycles
Solderability	>95%	EIA 364-52 Soldering Temperature : 260±5°C Soldering Time : 3~5 seconds

0.05" Centerline Through Hole PLCC IC Socket

PLCC Series

Dimensions in mm (for 20/28/44/52/68/84pin)

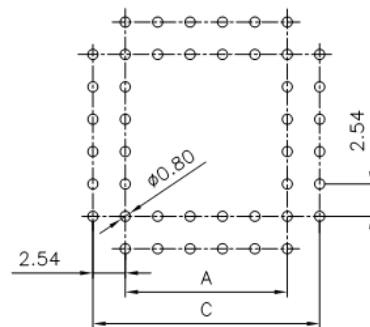
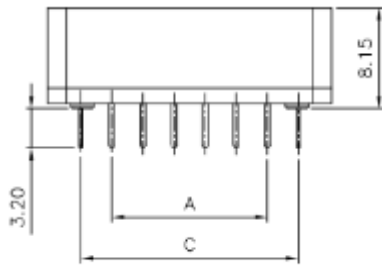
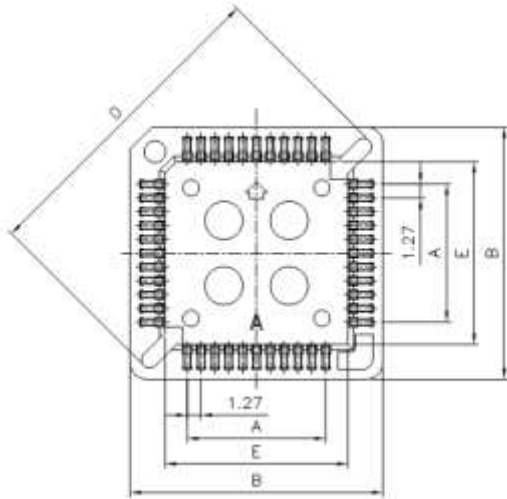

RECOMMEND PCB(V/T TYPE) LAYOUT
TOLERANCE=±0.05

PN	No. of Contacts	Dimension in mm				
		A±0.2	B±0.4	C±0.2	D±0.2	E±0.2
PLCC-20	20	5.08	15.56	10.16	18.46	9.16
PLCC-28	28	7.62	18.10	12.70	22.05	11.70
PLCC-44	44	12.70	23.18	17.78	29.24	16.78
PLCC-52	52	15.24	25.72	20.32	32.83	19.32
PLCC-68	68	20.32	30.80	25.40	40.02	24.40
PLCC-84	84	25.40	35.88	30.48	47.20	29.48

0.05" Centerline Through Hole PLCC IC Socket

PLCC Series

Dimensions in mm (only for 32pin)

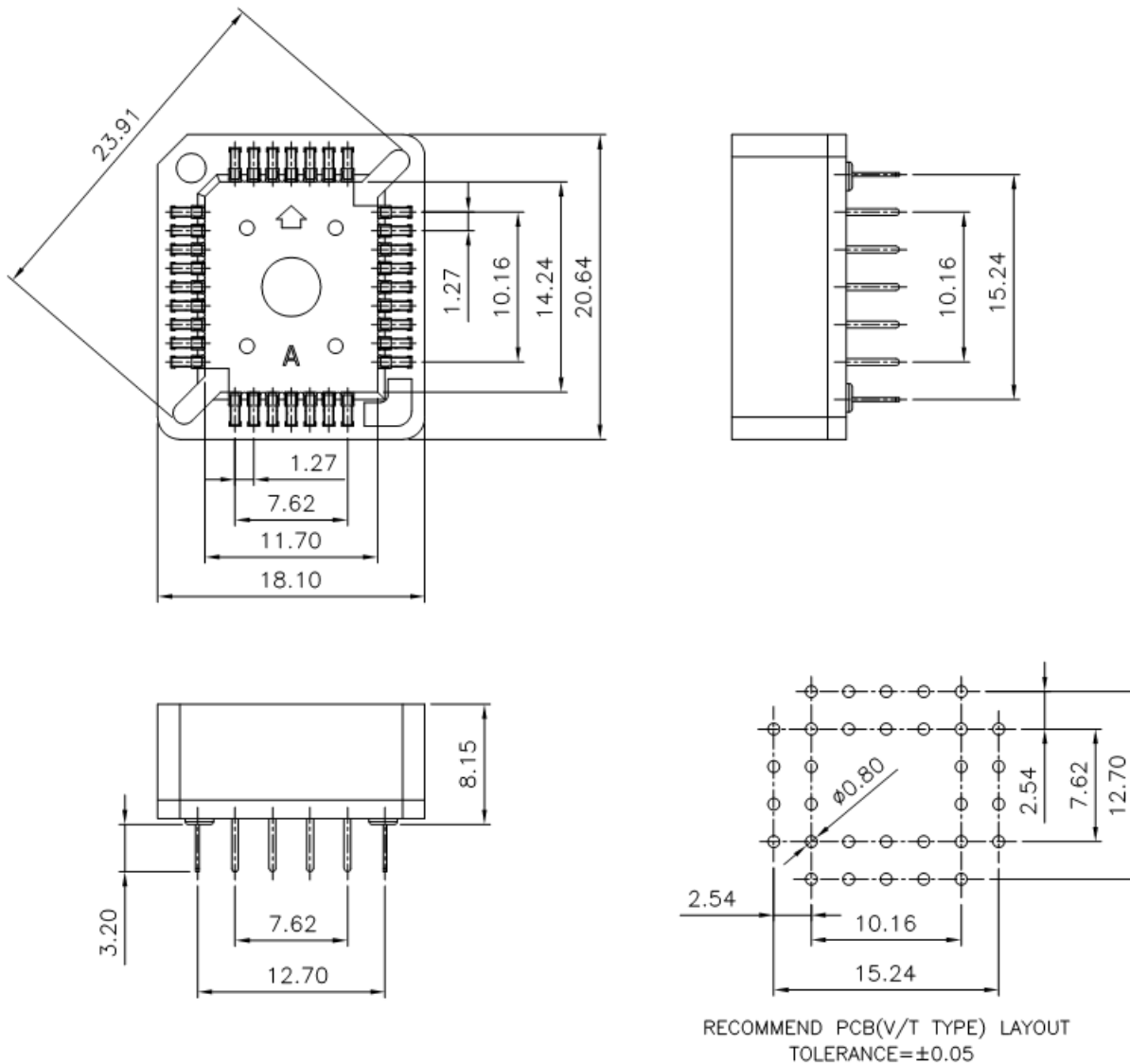

0.05" Centerline Through Hole PLCC IC Socket

PLCC Series

How to order:

PLCC – 20 – XX – C

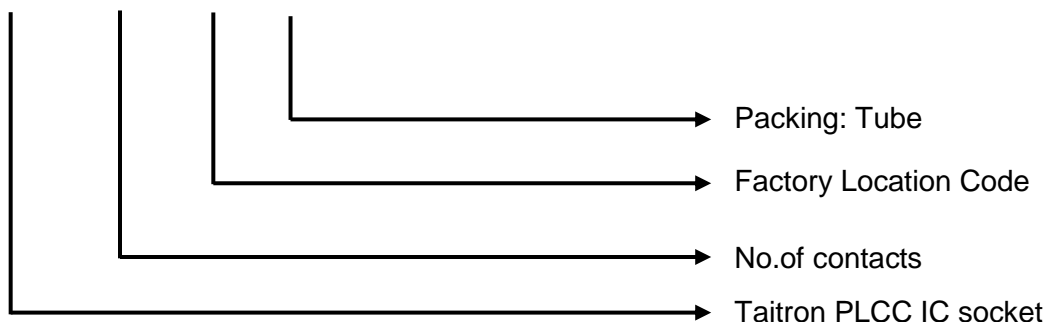

How to contact us

USA HEADQUARTERS

28040 WEST HARRISON PARKWAY, VALENCIA, CA 91355-4162

Tel: (800)-TAITRON (800)-824-8766 (661)-257-6060

Fax: (800)-TAITFAX (800)-824-8329 (661)-257-6415

Email: taitron@taitroncomponents.com

Http://www.taitroncomponents.com

TAITRON COMPONENTS INCORPORATED TAIWAN BRANCH

6F., NO.190, SEC. 2, ZHONGXING RD., XINDIAN DIST., NEW TAIPEI CITY 23146, TAIWAN R.O.C.

Tel: 886-2-2913-6238

Fax: 886-2-2913-6239

TAITRON COMPONENT TECHNOLOG SHANGHAI CORPORATION

SUITE 1503, METROBANK PLAZA, 1160 WEST YAN'AN ROAD, SHANGHAI, 200052, CHINA

Tel: +86-21-5424-9942

Fax: +86-21-2302-5027